

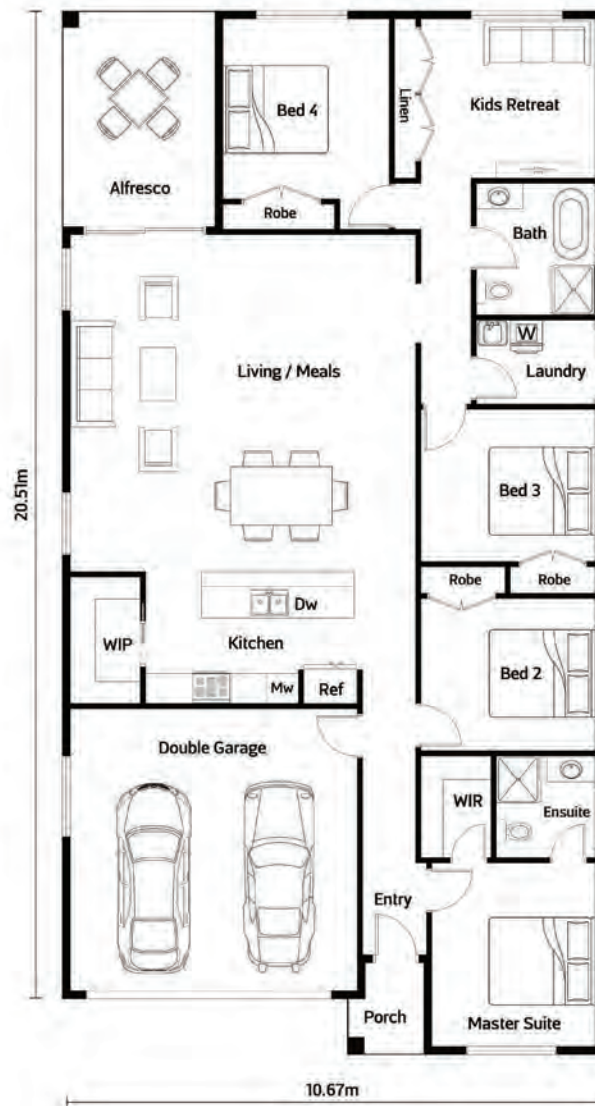

Lot Width 10.67m

Home Size 22.9sq



## LIVING AREAS

Living/Meals	6.57 x 6.70m
Kitchen	2.60 x 4.09m
Kids Retreat	3.07 x 3.40m
Double Garage	5.50 x 5.51m

## BEDROOMS

Bed 1	3.55 x 3.11m
Bed 2	3.00 x 3.40m
Bed 3	3.00 x 3.40m
Bed 4	3.49 x 3.21m

## OUTDOOR

Porch	TBA
Alfresco	4.20 x 3.00m

## HOME DETAILS

Ground Floor	164.69m <sup>2</sup>
Garage	33.12m <sup>2</sup>
Porch	2.34m <sup>2</sup>
Alfresco	12.6m <sup>2</sup>
Overall Width	10.67m
Overall Length	20.51m
<b>Total</b>	<b>212.75 m<sup>2</sup></b>

# Amber Façades



Aspire



Coastal



Contemporary



Governor



Hampton



Lifestyle



Mode

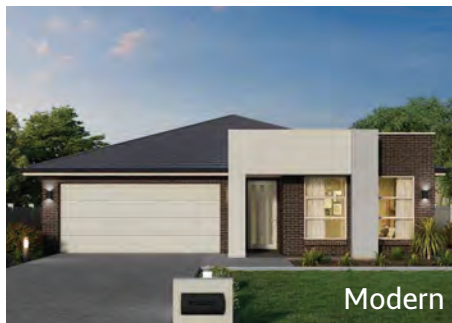

Modern



Traditional



Vogue

\* Copyright 2025 Crystele Homes. All drawings and photography are for illustrative purposes and should be used as a guide only. All photographs, Façades, colour schemes, floor plans and dimensions are for illustrative purposes only and may vary slightly to the end product. These items may consist of but are not limited to external landscaping, paths, paving, stone cladding, planter boxes, retaining walls, water features, pergolas, screens, clothes lines, render or textured features to masonry walls and decorative landscaping items such as fencing, outdoor kitchens, barbeques and feature lighting. Likewise internal features such as TV's, and audio systems, furniture, main floor & window coverings, garage door upgrades, roof upgrades, dishwasher, fridge, microwave, air conditioner, timber and stone flooring and cladding (natural or man-made) are also not included. Any prices on this website/ brochure do not include the supply of any of these items unless specifically noted. Crystele Homes reserves the right to revise plans, specifications, inclusions and prices without notice or obligation. For full list of inclusions and detailed home pricing, please contact Crystele Homes, ABN 52 123 978 674, Builder Licence Number 181646C. ©COPYRIGHT: Copyright of plans and documentation prepared by Crystele Homes shall remain the exclusive property of Crystele Designer Homes Pty Ltd unless a licence is issued otherwise. Unit 4, 39 Topham Rd, Smeaton Grange, NSW 2567, <https://crystelehomes.com.au/>

**HEAD OFFICE**  
4/39 Topham Rd,  
Smeaton Grange, NSW 2567

02 4648 1913  
[info@crystelehomes.com.au](mailto:info@crystelehomes.com.au)  
[crystelehomes.com.au](https://crystelehomes.com.au)

