

# The Norwich

SINGLE STOREY

Suits 8.5m frontage

BEDS	BATHS	CARSPACES
------	-------	-----------

4	2	1
---	---	---

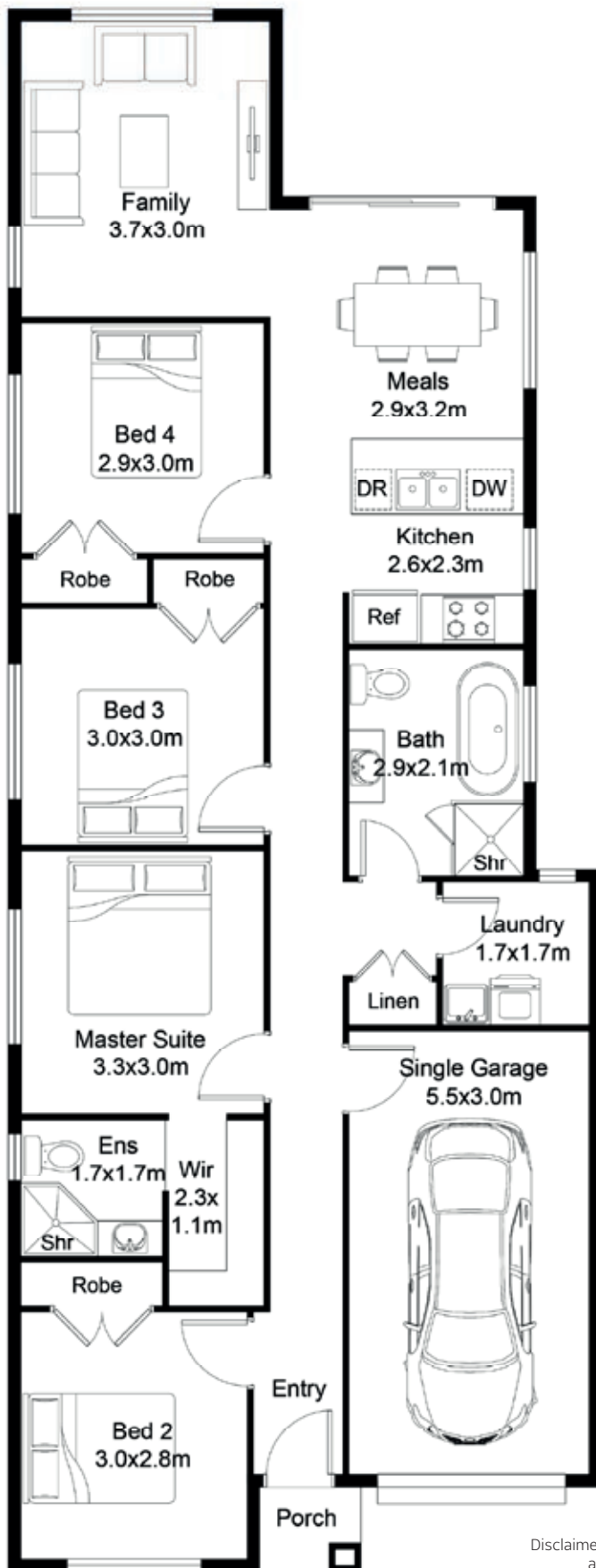

## MK I

Width	7.55m
Depth	19.79m
Ground floor	109.23m <sup>2</sup>
Garage	18.60m <sup>2</sup>
Porch	1.33m <sup>2</sup>

## HOUSE

129.16m <sup>2</sup>	14sq
----------------------	------

Disclaimer: All photographs, facades, colour schemes, floor plans and dimensions are for illustrative purposes only and may vary slightly to the end product.

BEDS	BATHS	CARSPACES
4	2	1

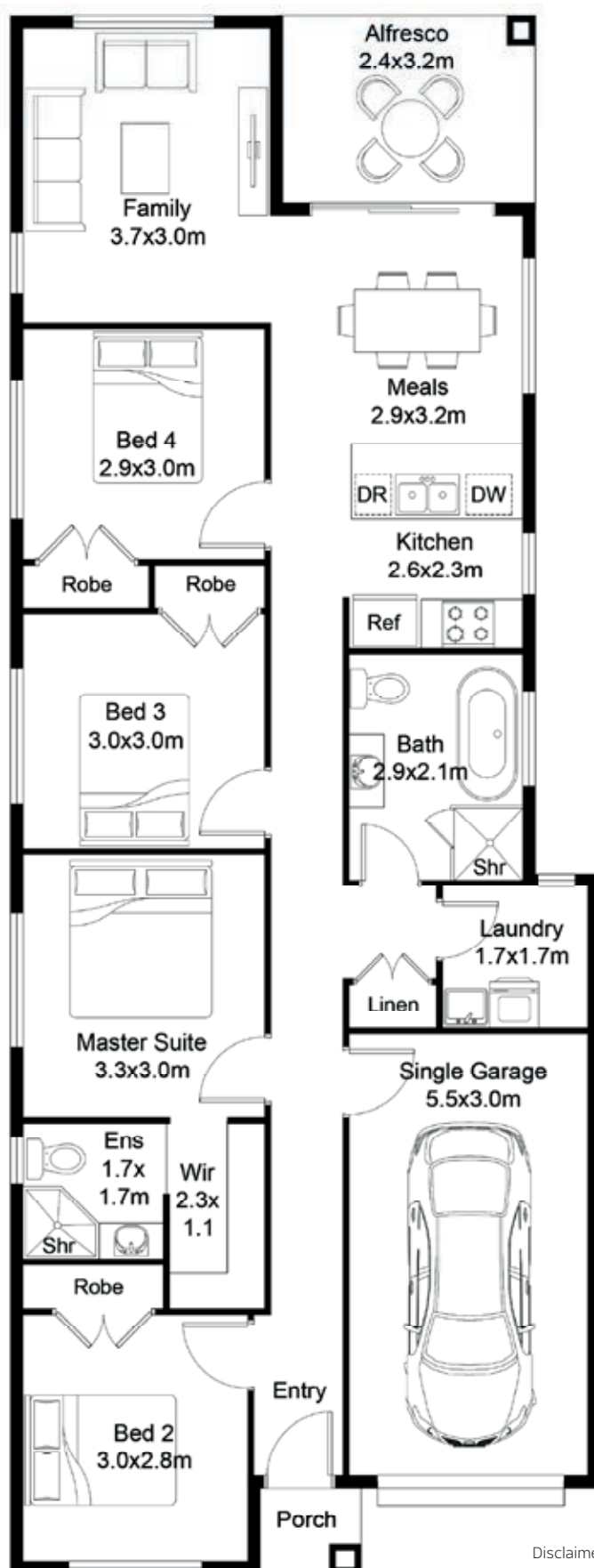

## MK II

Width	7.55m
Depth	19.79m
Ground floor	109.23m <sup>2</sup>
Garage	18.60m <sup>2</sup>
Porch	1.33m <sup>2</sup>
Alfresco	7.74m <sup>2</sup>

HOUSE	
136.90m <sup>2</sup>	15sq

Disclaimer: All photographs, facades, colour schemes, floor plans and dimensions are for illustrative purposes only and may vary slightly to the end product.