

Ground floor plan

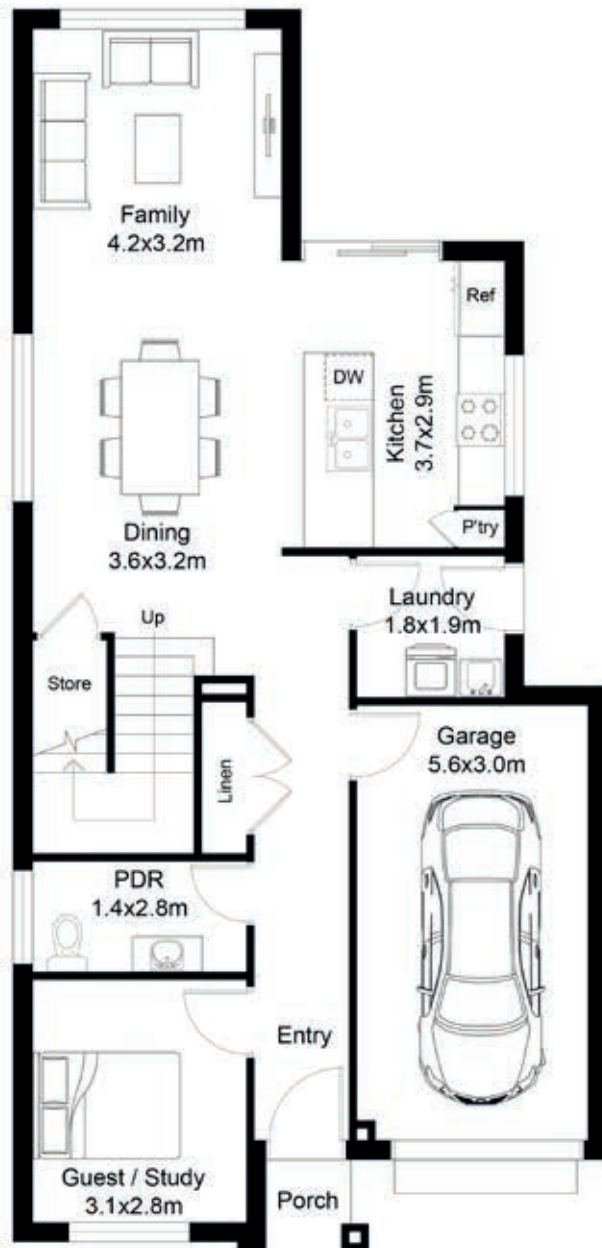

First floor plan

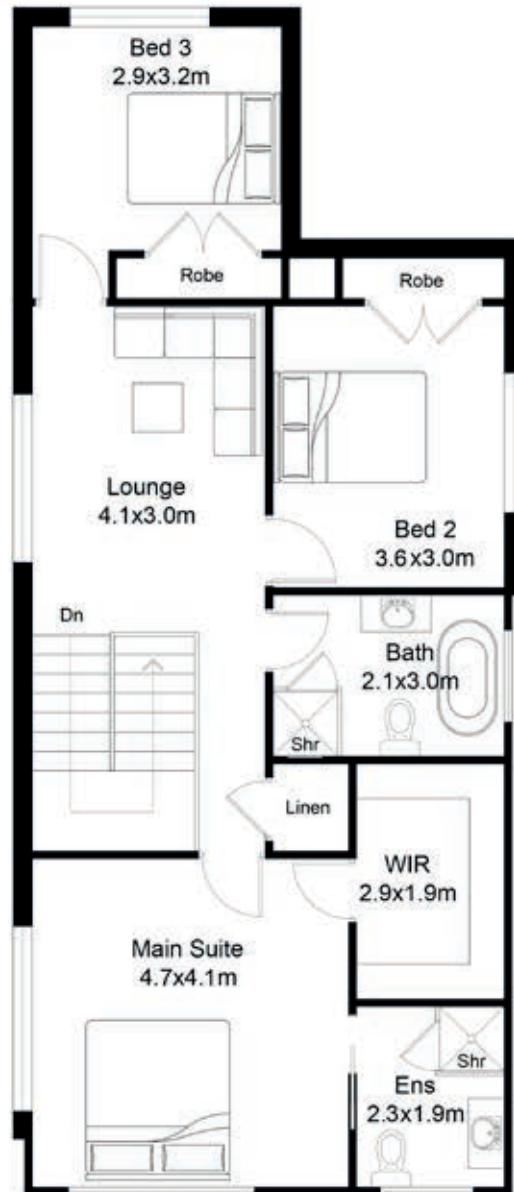

MK I

| | |
|--------------|---------------------|
| Width | 7.67m |
| Depth | 15.95m |
| Ground floor | 80.18m ² |
| First Floor | 88.59m ² |
| Garage | 19.28m ² |
| Porch | 1.29m ² |

HOUSE

189.34m² 20sq

Disclaimer: All photographs, facades, colour schemes, floor plans and dimensions are for illustrative purposes only and may vary slightly to the end product.

| BEDS | BATHS | CARSPACES |
|------|-------|-----------|
| 4 | 2.5 | 1 |

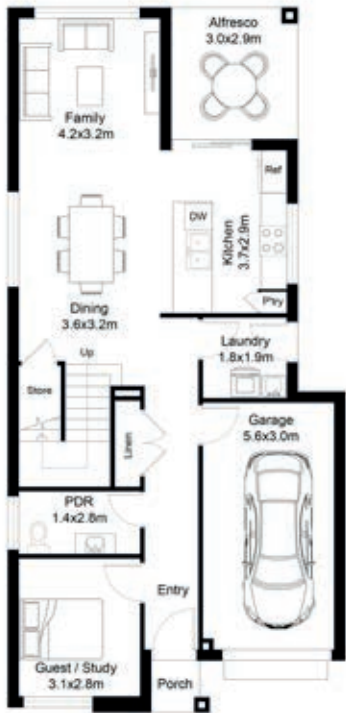

Ground floor plan



First floor plan

MK II

| | |
|--------------|---------------------|
| Width | 7.67m |
| Depth | 15.95m |
| Ground floor | 80.18m ² |
| First Floor | 88.59m ² |
| Garage | 19.28m ² |
| Porch | 1.29m ² |
| Alfresco | 8.64m ² |

HOUSE

197.98m² 21sq



Ground floor plan



First floor plan

MK III

| | |
|--------------|---------------------|
| Width | 7.67m |
| Depth | 18.95m |
| Ground floor | 88.82m ² |
| First Floor | 88.59m ² |
| Garage | 19.28m ² |
| Porch | 1.28m ² |
| Alfresco | 8.64m ² |

HOUSE

206.61m² 22sq

Disclaimer: All photographs, facades, colour schemes, floor plans and dimensions are for illustrative purposes only and may vary slightly to the end product.